

# SCL16-15

Precious metal commutation

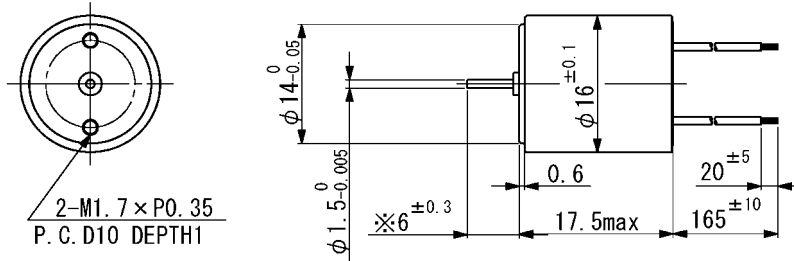

Weight 17.9 g  
Dimension in mm

Note) Dimension marked ※ is measured with shaft pushed against motor.

For combination with gearhead: SSG15

Ordering number				SCL16-15H2
1 Nominal voltage				12 V
2 Terminal resistance				117 Ω
3 Output power				0.3 W
4 Efficiency				74 %
5 No-load speed				7850 rpm
6 No-load current				2 mA
7 Stall torque				1.44 mNm
8 Friction torque				0.03 mNm
9 Back-EMF constant				1.5 mV/rpm
10 Torque constant				14.3 mNm/A
11 Slope of N-T curve				5460 rpm/mNm
12 Coil inductance				1.55 mH
13 Mechanical time constant				23.1 ms
14 Rotor inertia				0.4 gcm <sup>2</sup>

### Continuous operation

15 Speed range				6300 rpm
16 Max. torque				0.72 mNm

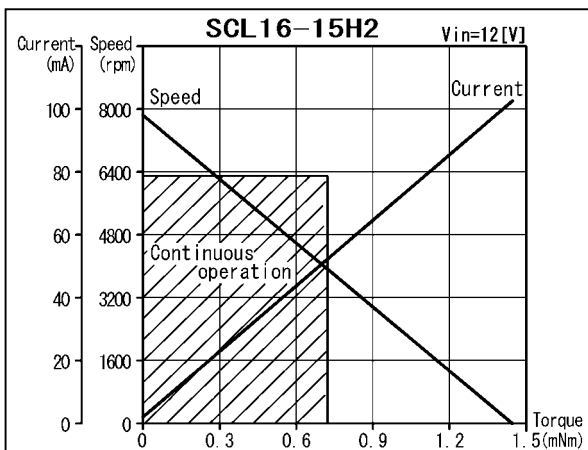

### General specifications

17 Operating temperature	-20...+60	°C
18 Max. coil temperature	+80	°C
19 Thermal resistances	$R_{th1} = 12, R_{th2} = 40$	K/W
20 Bearings type	Sintered sleeves	
21 Max. shaft radial load	1.2 (5 mm)	N
22 Max. shaft axial load	0.2	N
23 Max. axial load at standstill	9.8	N
24 Shaft radial play	0.05	mm
25 Shaft axial play	0.03...0.2	mm

**Options:** Lead wires length, shaft length, special coils, commutator with capacitors.