

DC CORELESS MOTOR SERIES

SCL12-22

Precious metal commutation

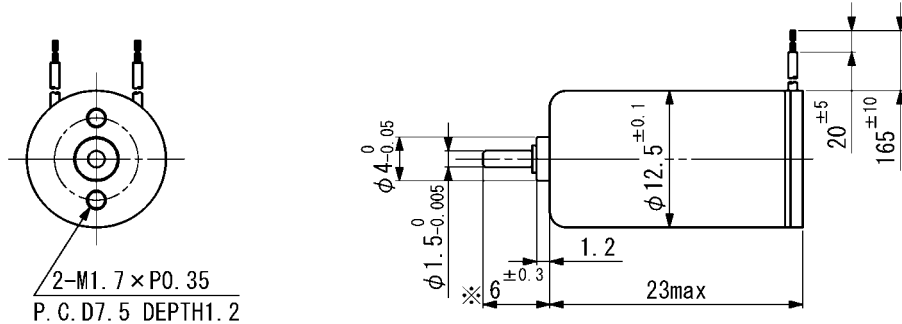

Weight 13.7 g
Dimension in mm

Note) Dimension marked * is measured with shaft pushed against motor.

For combination with gearheads: SSG12, SPG12

Ordering number		SCL12-2204	SCL12-2222
1 Nominal voltage		6	12 V
2 Terminal resistance		3.8	21.9 Ω
3 Output power		2.3	1.6 W
4 Efficiency		72	75 %
5 No-load speed		16800	14000 rpm
6 No-load current		35	10 mA
7 Stall torque		5.15	4.32 mNm
8 Friction torque		0.12	0.08 mNm
9 Back-EMF constant		0.35	0.84 mV/rpm
10 Torque constant		3.33	8.03 mNm/A
11 Slope of N-T curve		3270	3240 rpm/mNm
12 Coil inductance		0.05	0.36 mH
13 Mechanical time constant		11.7	9.7 ms
14 Rotor inertia		0.34	0.29 gcm ²

Continuous operation

15 Speed range		13400	11200 rpm
16 Max. torque		1.6	1.64 mNm

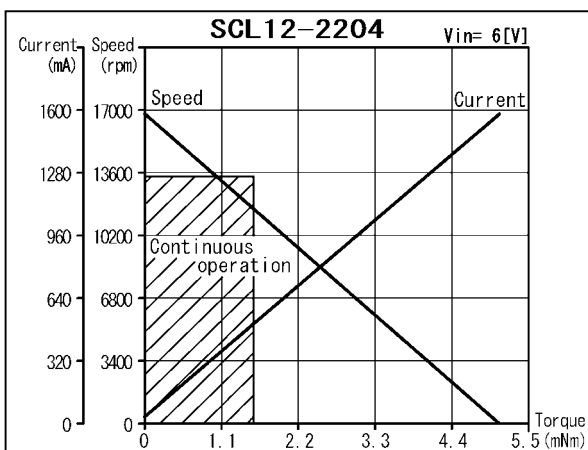

General specifications

17 Operating temperature	-20...+60	°C
18 Max. coil temperature	+80	°C
19 Thermal resistances	$R_{th1} = 10, R_{th2} = 35$	K/W
20 Bearings type	Sintered sleeves	
21 Max. shaft radial load	1.2 (5 mm)	N
22 Max. shaft axial load	0.2	N
23 Max. axial load at standstill	9.8	N
24 Shaft radial play	0.05	mm
25 Shaft axial play	0.03...0.2	mm

Options: Lead wires length, terminals instead of lead wires, shaft length, special coils, commutator with capacitors.