

SCL10-18

Precious metal commutation

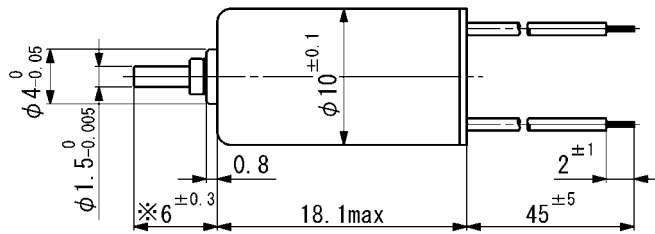
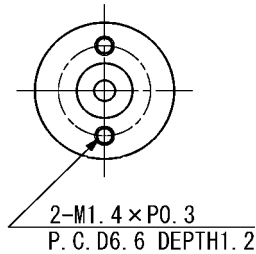

Weight 7.7 g

Dimension in mm

Note) Dimension marked ※ is measured with shaft pushed against motor.

For combination with gearheads: SSG10, SPG10

Ordering number			SCL10-1806	SCL10-1810
1 Nominal voltage			3	4 V
2 Terminal resistance			5.7	10 Ω
3 Output power			0.36	0.36 W
4 Efficiency			62	59 %
5 No-load speed			12000	12800 rpm
6 No-load current			24	22 mA
7 Stall torque			1.14	1.07 mNm
8 Friction torque			0.05	0.06 mNm
9 Back-EMF constant			0.24	0.3 mV/rpm
10 Torque constant			2.28	2.82 mNm/A
11 Slope of N-T curve			10500	12000 rpm/mNm
12 Coil inductance			0.07	0.09 mH
13 Mechanical time constant			12.1	11.3 ms
14 Rotor inertia			0.11	0.09 gcm ²

Continuous operation

15 Speed range			9600	10200 rpm
16 Max. torque			0.57	0.53 mNm

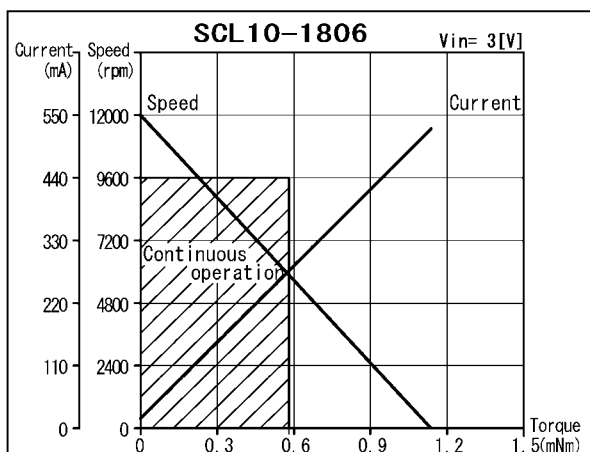

General specifications

17 Operating temperature	-20...+60	°C
18 Max. coil temperature	+80	°C
19 Thermal resistances	$R_{th1} = 11, R_{th2} = 57$	K/W
20 Bearings type	Sintered sleeves	
21 Max. shaft radial load	1.2 (5 mm)	N
22 Max. shaft axial load	0.2	N
23 Max. axial load at standstill	9.8	N
24 Shaft radial play	0.05	mm
25 Shaft axial play	0.03...0.2	mm

Options: Lead wires length, shaft length, special coils, commutator with capacitors.